

# EAGLEWOOD, P.U.D.

PL. 8 9  
 PG 26

BEING A PART OF SECTIONS 27 AND 28, TOWNSHIP 39 SOUTH, RANGE 42 EAST, MARTIN COUNTY, FLORIDA

TYPICAL 5' SIDE YARD SETBACK ON LEFT OF LOTS AS FOLLOWS: LOT 132, 133, 134, 135, 136, 137, 138, 139, 140, 141, 143, 144, 145, 146, 147, 148, 149, 151, 152 & 153

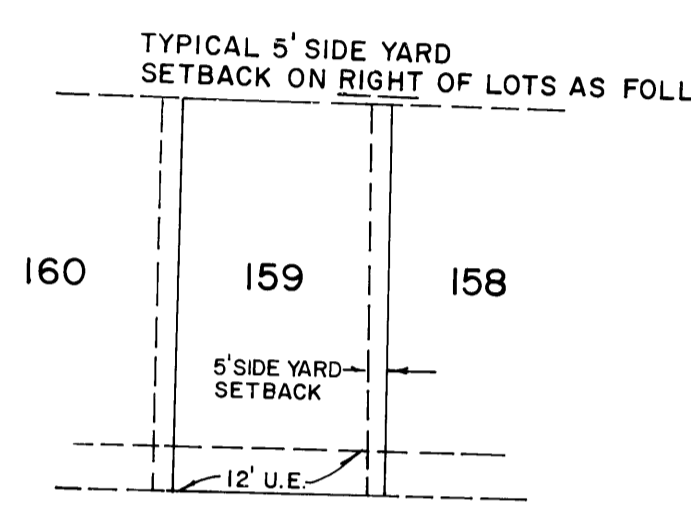
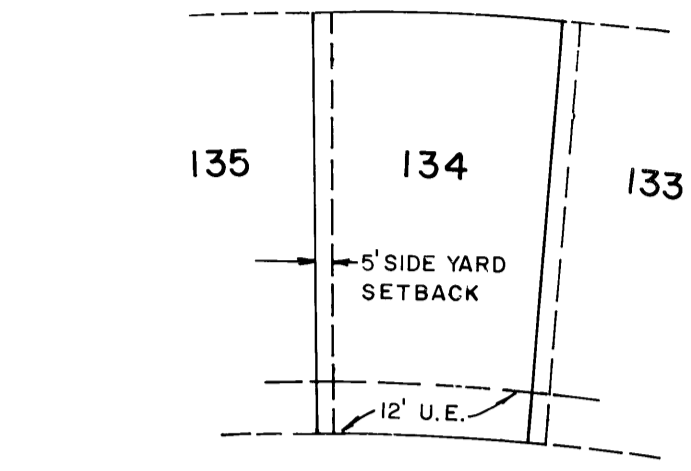

LINE	BEARING	DISTANCE
1	S 16°24'52"W	35.16
2	S 36°52'12"W	25.00
3	N 49°50'38"E	41.87
4	N 22°00'41"E	50.70
5	N 72°17'58"E	48.34
6	S 58°34'14"E	42.18
7	S 28°01'47"E	47.85
8	S 11°58'39"W	53.15
9	S 71°08'49"E	43.32
10	S 34°18'48"E	48.65
11	S 48°48'51"E	53.15
12	S 50°27'18"E	49.23

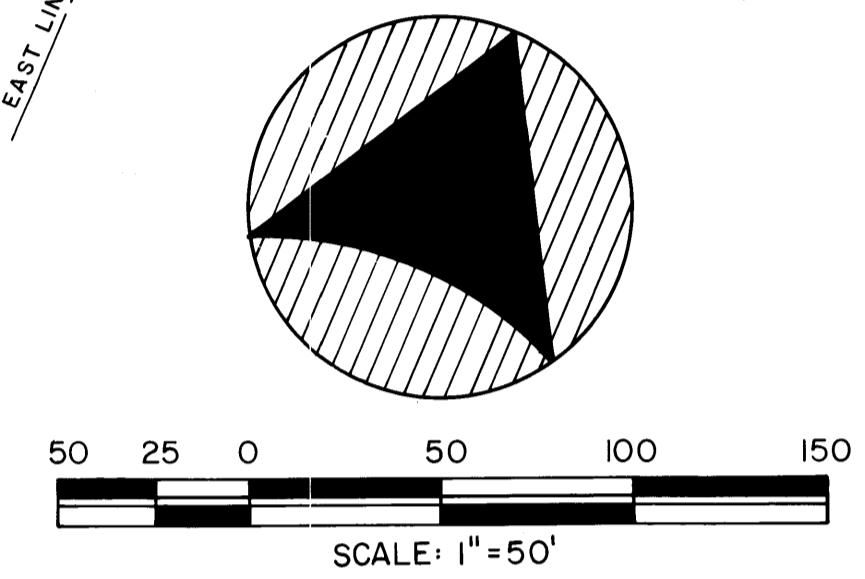

PREPARED BY:  
**HOLLY & WEBER, INC.**  
 ENGINEERS-PLANNERS-SURVEYORS  
 601 S. FEDERAL HIGHWAY - STUART, FLORIDA  
 (305) 286-7770

- SURVEY NOTES:**
- INDICATES FOUND PERMANENT REFERENCE MONUMENT (P.R.M.)
  - INDICATES SET PERMANENT REFERENCE MONUMENT (P.R.M.)
  - INDICATES PERMANENT CONTROL POINT (P.C.P.)
  - U.E. INDICATES UTILITY EASEMENT
  - D.E. INDICATES DRAINAGE EASEMENT
  - A.E. INDICATES ACCESS EASEMENT
  - (R) INDICATES RADIAL LINE
  - BEARINGS SHOWN HEREON ARE RELATIVE TO U.S. 1 (S.R. #5), FLORIDA DEPARTMENT OF TRANSPORTATION SECTION #89010-2102, DATED MAY 23, 1938.
  - THERE WILL BE NO LOT SPLITS EXCEPT TO CREATE LARGER LOTS.